

## DALI bus Power Supply

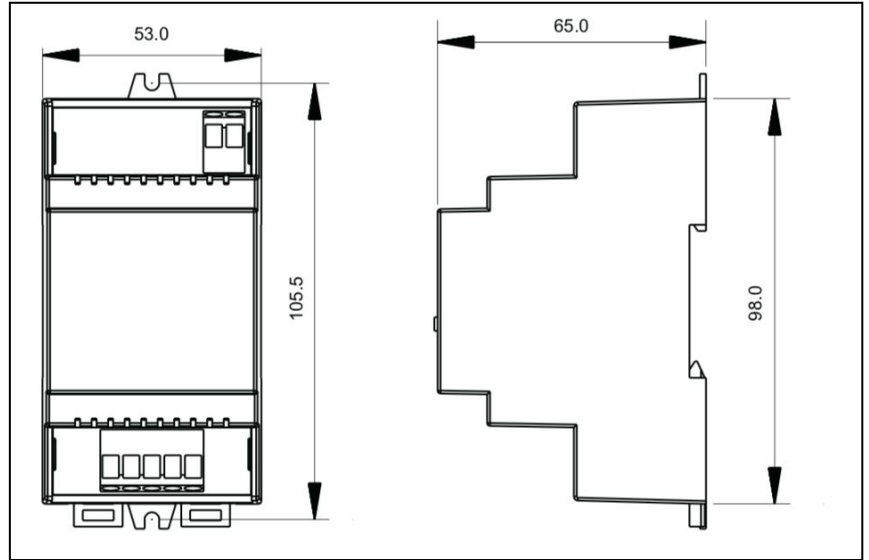

<b>Body construction</b>	Plastic – Din rail mount – or surface mount
<b>Ports</b>	Push in connector blocks – with press release
<b>Supply in</b>	230V AC 50Hz
<b>Typical DALI network features</b>	<p style="text-align: center;">250mA 16V .</p> <p>The 250mA needs to be factored in when adding the consumption of all the devices attached to the DALI bus.</p> <p>Volt drop needs to be factored in – maximum permissible volt drop is 2V – (so 14V DC)</p> <p style="text-align: center;">No more that 16 DALI groups allowed. No more that 16 DALI scenes allowed.</p> <p>Booster devices need to be added to the bus if these parameters are exceeded.</p>
<b>IP rating</b>	IP20

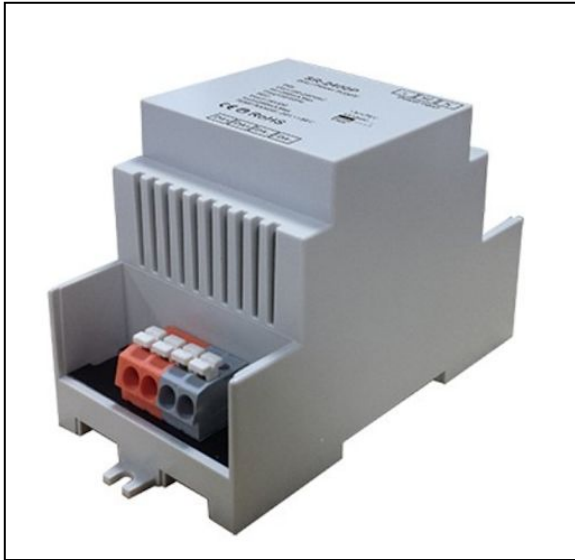